

EC-126 Helicopter EC-126S Helicopter - Surface Mount

Parts List			
DESCRIPTION	EC-126	EC-126S	PART NUMBER
90° ANGLE BRACKET	50	50	302334
HELICOPTER DECK PANEL	1	1	304907
HELICOPTER SIDE PANEL	2	2	304908
HELICOPTER FRONT PANEL	1	1	304909
HELICOPTER TAIL ROTOR BLADE PANEL	2	2	304915
HELICOPTER FOOT PEDAL PANEL	4	4	304916
HELICOPTER CONSOLE TOP PANEL	1	1	304919
HELICOPTER SEAT SUPPORT PANEL	4	4	304921
HELICOPTER SEAT KICK PLATE PANEL	2	2	304922
HELICOPTER SEAT PANEL	2	2	304923
HELICOPTER BACK SEAT PANEL	2	2	304924
HELICOPTER BLADE PANEL	1	1	304927
HELICOPTER BLADE W/TOP SLOTTED PANEL	1	1	304928
HELICOPTER PONTOON ASS'Y	1	1	304929
SUPPORT LEG W/90° BEND	4	0	304938
ANGLE BRACKET	4	4	304980
CLEAR POLYCARBONATE BUBBLE	1	1	304982
FOOT PEDAL WELD ASS'Y	2	2	305000
SUPPORT MOUNT BRACKET	0	4	305087
HELICOPTER CONSOLE	1	1	306117
HELICOPTER CONSOLE SUPPORT PANEL	2	2	306178
HELICOPTER BACK PANEL	1	1	306199
TAIL SIDE PANEL	2	2	311755
ROTOR FRONT PANEL	1	1	311756
ROTOR BACK PANEL	1	1	311757
TAIL TOP PANEL	1	1	311758
LONG NOTCHED BRACE	1	1	311759
SMALL NOTCHED BRACE	1	1	311760
LONG SPACER	1	1	311761
SMALL SPACER	1	1	311762
HELICOPTER ROTOR SHANK WELD ASS'Y	1	1	311764
HELICOPTER ROTOR SHANK SHAFT WELD ASS'Y	1	1	311766
HELICOPTER SUPPORT	1	0	311170
SUPPORT ASS'Y	0	1	311175
HARDWARE COMPLETE	1	0	311171
HARDWARE COMPLETE	0	1	311172
WHITE PLASTIC WASHER	4	4	304071*
WHITE PLASTIC CAP	4	4	304072*
3/8" x 3/4" CARRIAGE BOLT	107	107	800252*
3/8" x 3/4" P.B.H.C.S. w/PATCH	20	20	812052*
3/8" x 1" CARRIAGE BOLT	1	1	800253*
3/8" x 1" P.B.H.C.S. w/PATCH	5	5	812050*

EC-126 Helicopter EC-126S Helicopter - Surface Mount

Parts List			
DESCRIPTION	EC-126	EC-126S	PART NUMBER
3/8" x 1 1/4" P.B.H.C.S. w/PATCH	2	2	812051*
3/8" x 1 1/2" CARRIAGE BOLT	2	2	800255*
3/8" x 1 3/4" P.B.H.C.S. w/PATCH	2	2	812054*
3/8" x 2 1/4" P.B.H.C.S. w/PATCH	4	4	812056*
3/8" x 2 3/4" WEDGE ANCHOR	0	7	800076*
3/8" x 5 3/4" HEX HEAD BOLT	4	4	801051*
3/8" LOCKWASHER	0	7	817334*
3/8" FLAT WASHER	39	41	817410*
3/8" FLAT WASHER (1 1/4" O.D.)	2	2	817424*
3/8" LOCK NUT	4	4	804353*
3/8" BARREL NUT	139	139	804804*
1/2" I.D. BRONZE BUSHING	4	4	102820*
1/2" x 4" CARRIAGE BOLT	4	4	800366*
1/2" LOCKWASHER	4	4	817342*
1/2" FLAT WASHER	4	4	817412*
1/2" FLAT WASHER (1 3/8" O.D.)	1	1	817425*
1/2" LOCKNUT	1	1	804355*
1/2" HEX NUT	4	4	804055*

Unless Otherwise Specified, All Units of Measure are Each

**Items listed below Hardware Complete line are included with Hardware Complete Number*

Warning: During Installation, Hardware And Small Parts Are Choking Hazards For Young Children. Store Unused Parts Appropriately Until Assembly Is Completed. Once Assembly Is Completed, Remove Any Unused Parts From The Play Environment And Dispose/Save Them In A Secure Location. Any bolt end protruding more than two full threads beyond the face of the nut causes risk of clothing entanglement.

Promptly cut-off flush, file smooth, and treat to prevent corrosion.

Note: Peen Tee-Nuts and Flatwashers to match radius of pipe after assembly is complete.

Note: Loctite (supplied by others) should be used on any non-patch hardware.

SPECIFICATIONS:

PONTOON: 2-3/8" O.D. and 5" O.D. galvanized steel tubing welded with stainless steel and powder-coated after fabrication. End caps are powder-coated cast aluminum, factory-riveted in place.

PANELS: High-density .750" thick extruded solid polyethylene with color molded in and UV-stabilized.

BUBBLE: Bubble made of clear polycarbonate 1/4" thickness and 24" diameter.

BOLT CAPS: Injection molded polypropylene, UV-stabilized, white in color.

BRACKETS: Formed from 10 GA. galvanized steel, powder-coated after fabrication.

SHAFT: Made of 1/2" all thread rod, 3/16" plates and oil-impregnated bushing. Powder coated after fabrication.

HARDWARE: Primary hardware is stainless steel.

EC-126 Helicopter *EC-126S Helicopter - Surface Mount*

INSTALLATION INSTRUCTIONS:

1. Dig footings as shown in the footing diagram.
2. Attach Blade Panel and Blade w/Top Slotted Panel to Rotor Shank using 3/8" x 3/4" P.B.H.C.S. w/Patch, 3/8" Flat Washer, and 3/8" Barrel Nut. See Sheet 6.
3. Attach the assembled rotor blade to the Rotor Shank Shaft Ass'y using 1/2" Bronze Bushing, 1/2" Flat Washer (1 3/8" O.D.) and 1/2" Lock Nut. Attach Long Notched Brace and Long Spacer to the Rotor Front Panel using 3/8" x 2 1/4" P.B.H.C.S. w/Patch, 3/8" Flat Washer, and 3/8" Barrel Nut. Attach Small Notched Brace and Small Spacer to Rotor Back Panel using 3/8" x 2 1/4" P.B.H.C.S. w/Patch, 3/8" Flat Washer, and 3/8" Barrel Nut. Then attach both to the Rotor Shank Shaft Ass'y using 3/8" x 3/4" P.B.H.C.S. w/Patch, 3/8" Flat Washer, and 3/8" Barrel Nut. See Sheet 7.
4. Attach the Assembled Rotor Housing to the Tail Side Panel using 3/8" x 3/4" P.B.H.C.S. w/Patch, 3/8" Flat Washer, and 3/8" Barrel Nut. Attach Tail Rotor Blade to Tail Side Panel using 3/8" x 1 3/4" P.B.H.C.S. w/Patch, 3/8" Flat Washer (1 1/4" O.D.), 1/2" I.D. Bronze Bushing, and 3/8" Barrel Nut. Attach Helicopter Support to Tail Side Panel using 3/8" x 1" P.B.H.C.S. w/Patch, 3/8" Flat Washer, 90° Angle Bracket, and 3/8" Barrel Nut. Attach 90° Angle Bracket to Tail Side Panel using 3/8" x 3/4" Carriage Bolt and 3/8" Barrel Nut. Attach Angle Bracket to Tail Side Panel using 3/8" x 3/4" Carriage Bolts and 3/8" Barrel Nut. Repeat this step with other Tail Side Panel. See Sheet 8.
5. Attach Tail Top Panel to the two assembled Tail Side Panels using 3/8" x 3/4" Carriage Bolts and 3/8" Barrel Nut. See Sheet 9.
6. Attach Console Top Panel to Console using 3/8" x 1 1/4" P.B.H.C.S. w/Patch, 3/8" Flat Washer, and 3/8" Barrel Nut. Attach Console to Console Support Panel using 90° Angle Bracket, 3/8" x 3/4" Carriage Bolt and 3/8" Barrel Nut. Attach 90° Angle Brackets to Bottom of Console Support Panels using 3/8" x 3/4" Carriage Bolt and 3/8" Barrel Nut. See Sheet 10.
7. Attach Seat Back Panel to Seat Support Panel using 90° Angle Bracket, 3/8" x 3/4" Carriage Bolt, and 3/8" Barrel Nut. Place Seat Kick Plate Panel into slots of Seat Support Panels. Attach 90° Angle Bracket to bottom of the Seat Support Panel using 3/8" x 3/4" Carriage Bolt and 3/8" Barrel Nut. Attach Seat Panel to Seat Support Panel using 90° Angle Bracket, 3/8" Carriage Bolt, and 3/8" Barrel Nut. See Sheet 11.
8. Attach Assembled Seat to Deck Panel using 3/8" x 3/4" Carriage Bolt and 3/8" Barrel Nut. Attach Assembled Console to Deck Panel using 3/8" x 3/4" Carriage Bolt and 3/8" Barrel Nut. Attach Foot Pedal Panel to Foot Pedal Ass'y using 3/8" x 3/4" Carriage Bolt and 3/8" Barrel Nut. Attach 90° Angle Bracket to ends of Foot Pedal Ass'y using 3/8" x 1" P.B.H.C.S. w/Patch and 3/8" Flat Washer. Slide Foot Pedal Ass'y into the slot of the Console Support Panel. Attach Foot Pedal Ass'y to Deck Panel using 90° Angle Bracket, 3/8" x 3/4" Carriage Bolt, and 3/8" Barrel Nut. See Sheet 12.
9. Attach Back Panel to Deck Ass'y using 90° Angle Bracket, 3/8" x 3/4" Carriage Bolt, and 3/8" Barrel Nut. Attach Tail Ass'y to Back Panel using 3/8" x 3/4" Carriage Bolt and 3/8" Barrel Nut. Attach Side Panel to Deck Ass'y using 90° Angle Bracket, 3/8" x 3/4" Carriage Bolt, and 3/8" Barrel Nut. Attach Front Panel to Deck Ass'y using 90° Angle Bracket, 3/8" x 3/4" Carriage Bolt, and 3/8" Barrel Nut. Attach Side Panel to Deck Ass'y using 90° Angle Bracket, 3/8" x 3/4" Carriage Bolt, and 3/8" Barrel Nut. Attach all these panels together using 90° Angle Bracket, 3/8" x 3/4" Carriage Bolt, and 3/8" Barrel Nut. See Sheet 13.
10. Attach Assembled Cockpit and Tail to Pontoon using 1/2" x 4" Carriage Bolt, 1/2" Lock Washer, 1/2" Flat Washer, and 1/2" Hex Nut. Attach Clear Polycarbonate Bubble to Assembled Cockpit using 3/8" x 3/4" P.B.H.C.S. w/Patch, 3/8" Flat Washer, and 3/8" Barrel Nut. See Sheet 14.
11. Attach the Support Legs to the Pontoons using White Plastic Cap, 3/8" x 5 3/4" Hex Head Bolt, 3/8" Flat Washer, White Plastic Washer, and 3/8" Hex Nut as shown in the assembly diagram (sheet 15). Brace, plumb, and level the assembly into the footing holes and pour concrete footing within 4" to the top of posts and taper away for good water drainage. Allow at least 24 hours curing time before proceeding.

Optional Surface Mounting:

Attach Surface Mount Brackets to the Pontoons using White Plastic Cap, 3/8" x 5 3/4" Hex Head Bolt, 3/8" Flat Washer, White Plastic Washer, and 3/8" Hex Nut as shown on sheet 15. Use Expansion-Type Anchor Bolts (supplied by others) to fasten the assembly on a minimum pre-existing 4" thick concrete slab (supplied by others).

EC-126 Helicopter
EC-126S Helicopter - Surface Mount

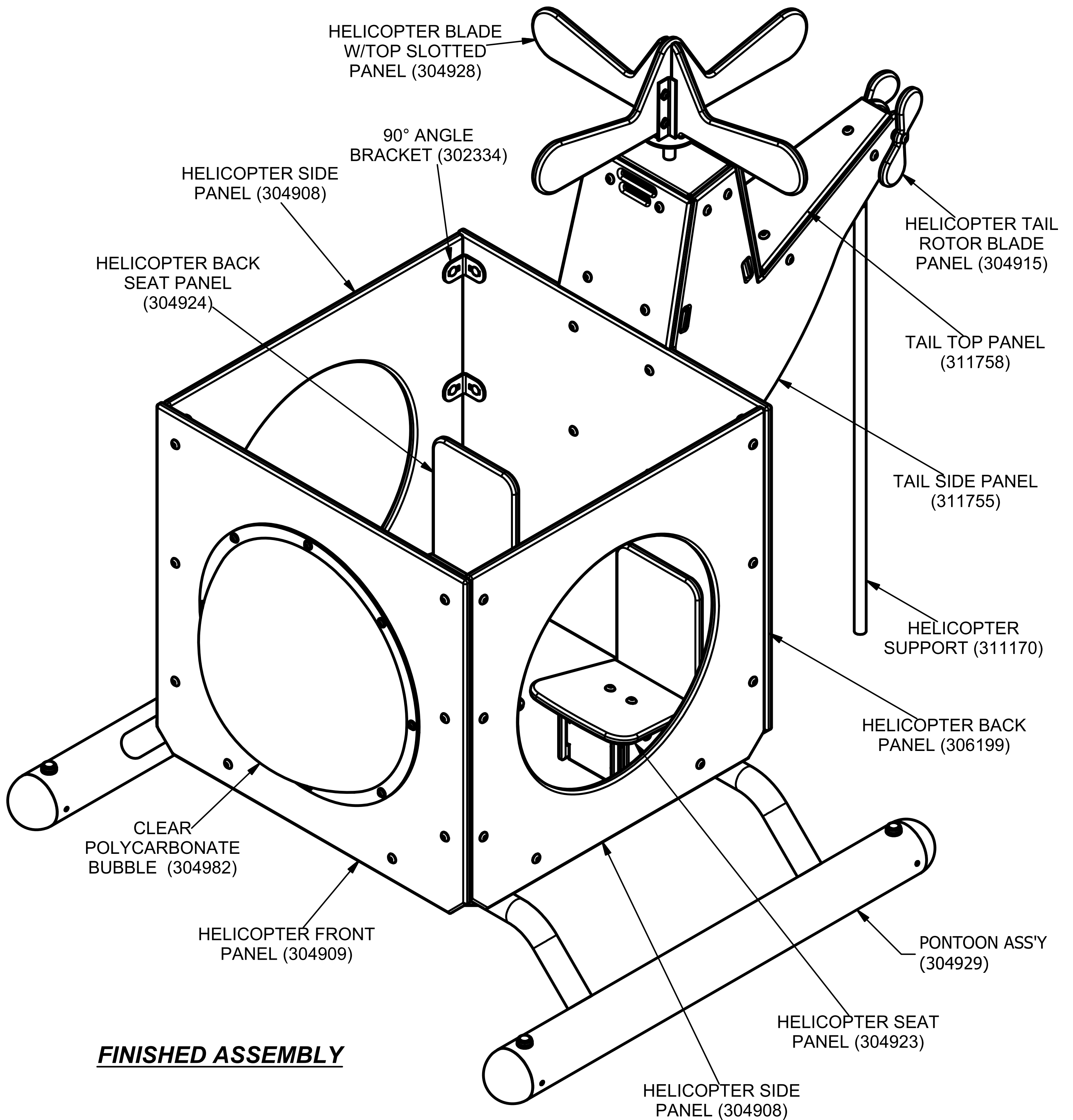

EC-126 Helicopter
EC-126S Helicopter - Surface Mount

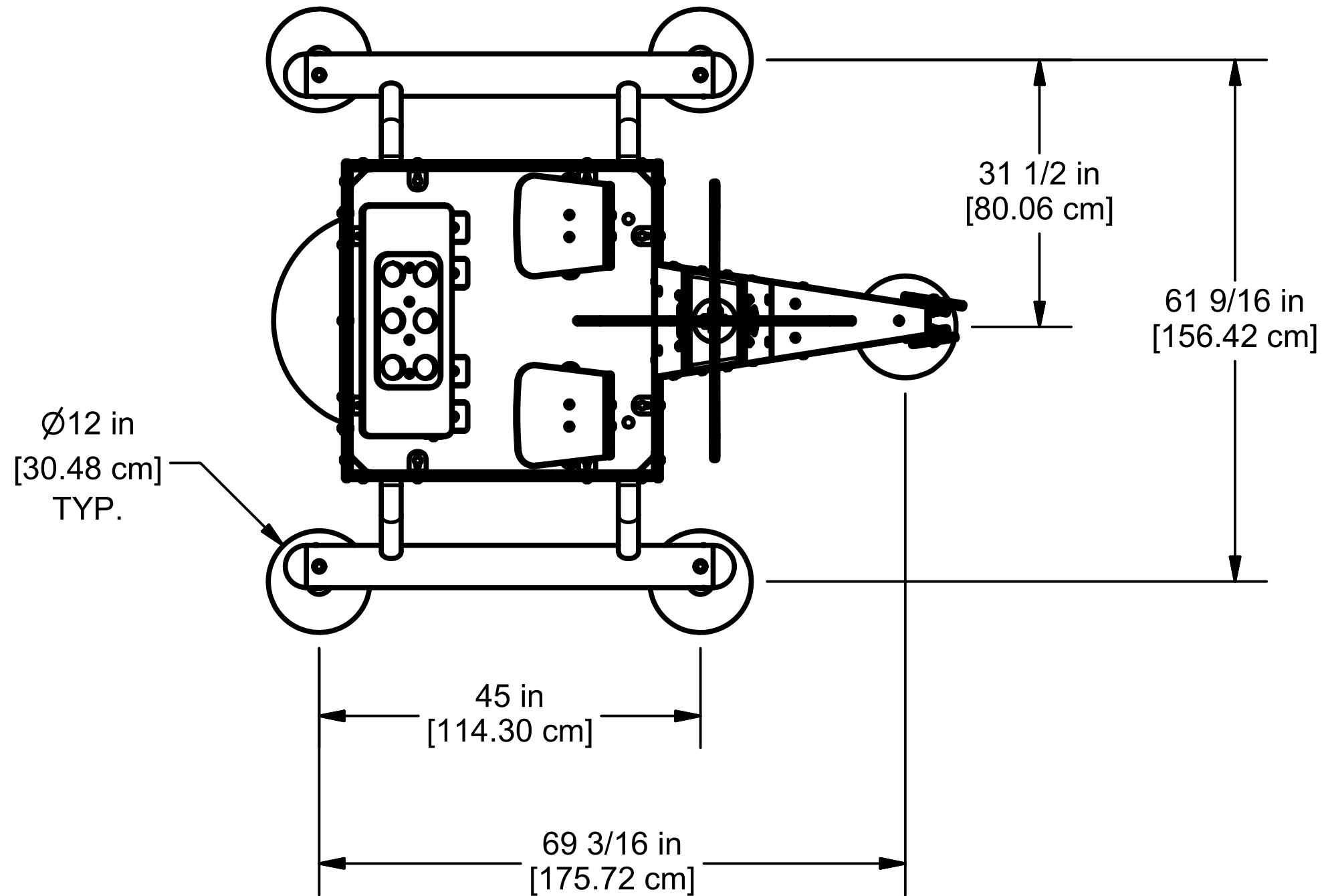

PLAN VIEW

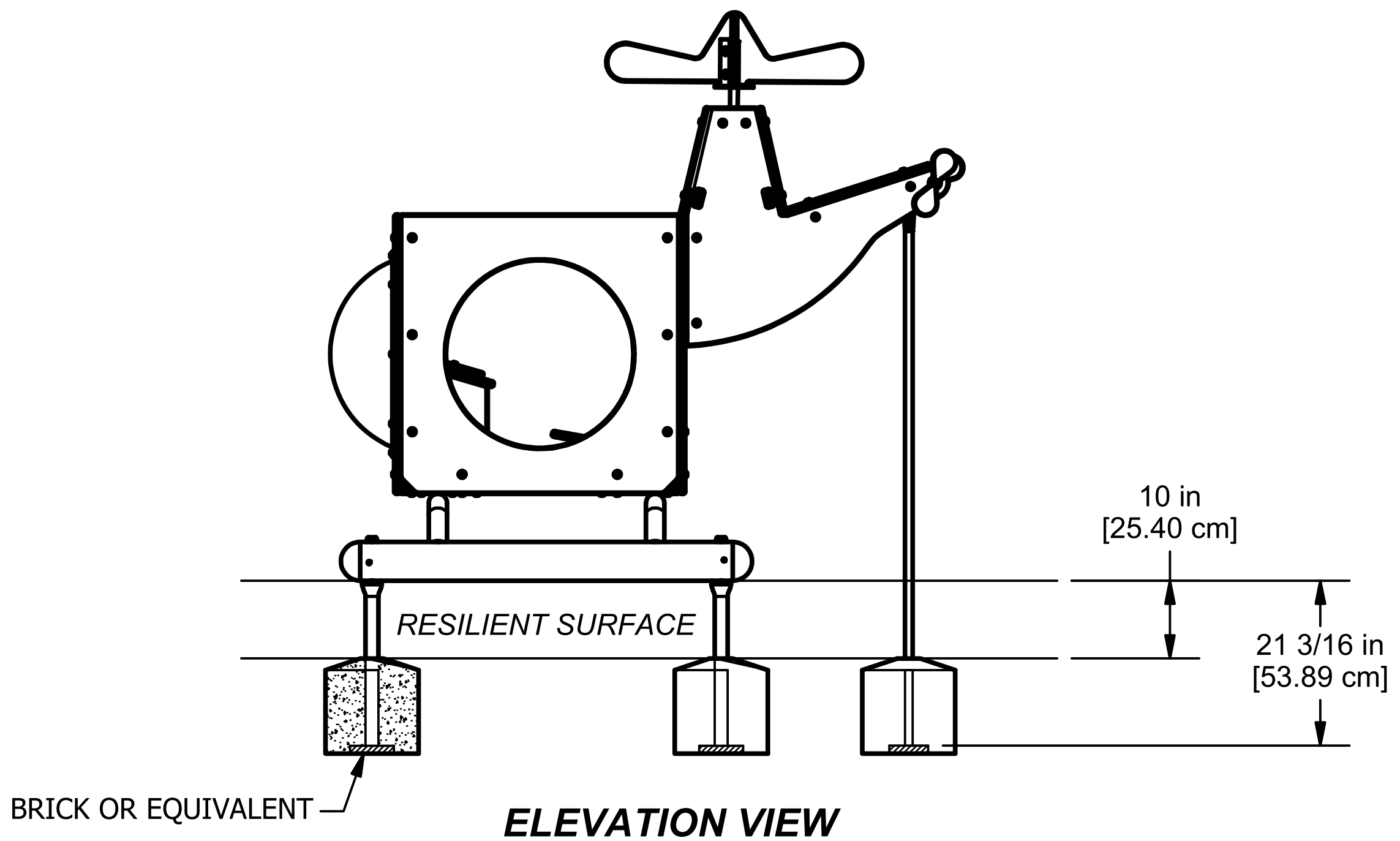

ELEVATION VIEW

EC-126 Helicopter
EC-126S Helicopter - Surface Mount

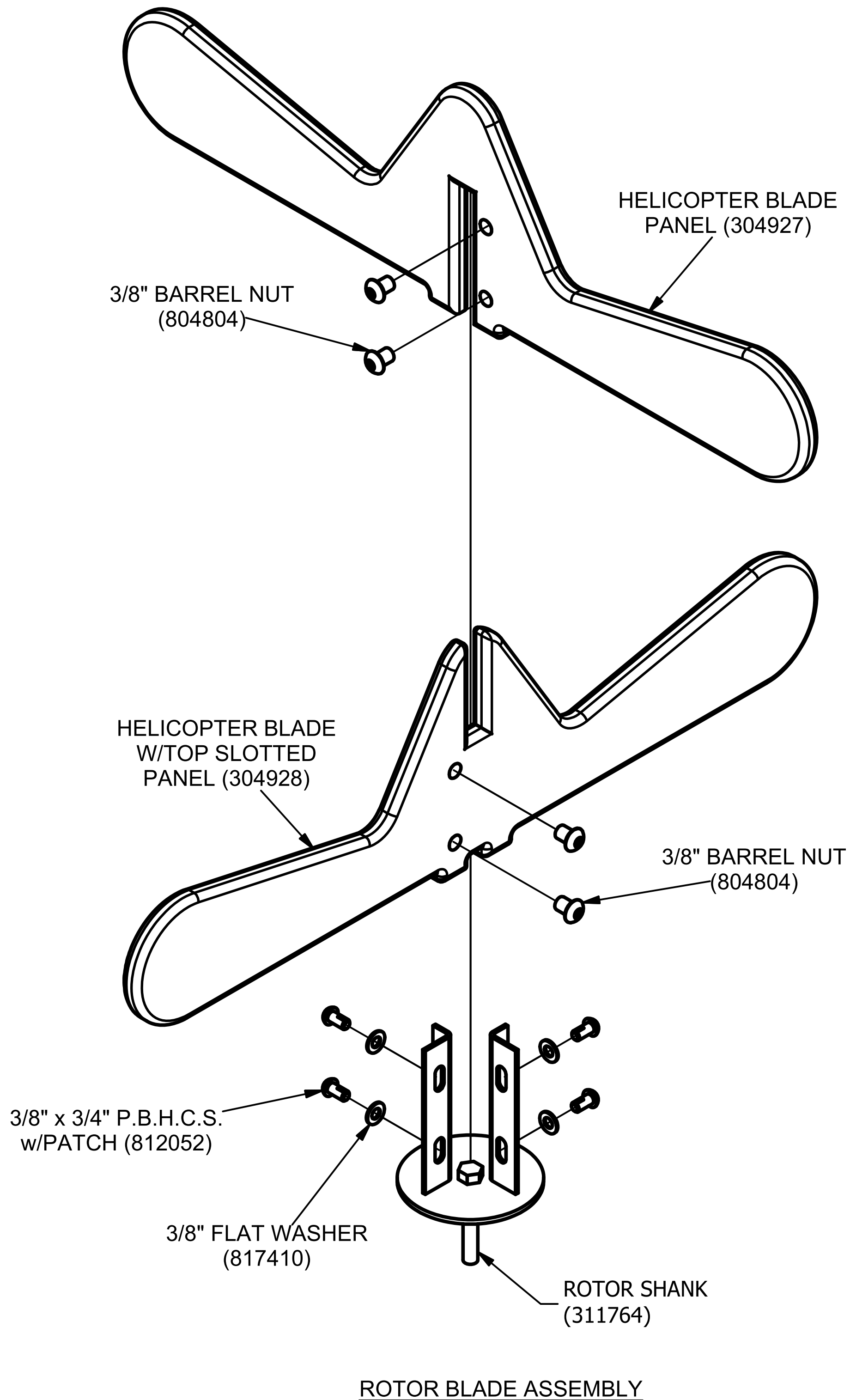

EC-126 Helicopter
EC-126S Helicopter - Surface Mount

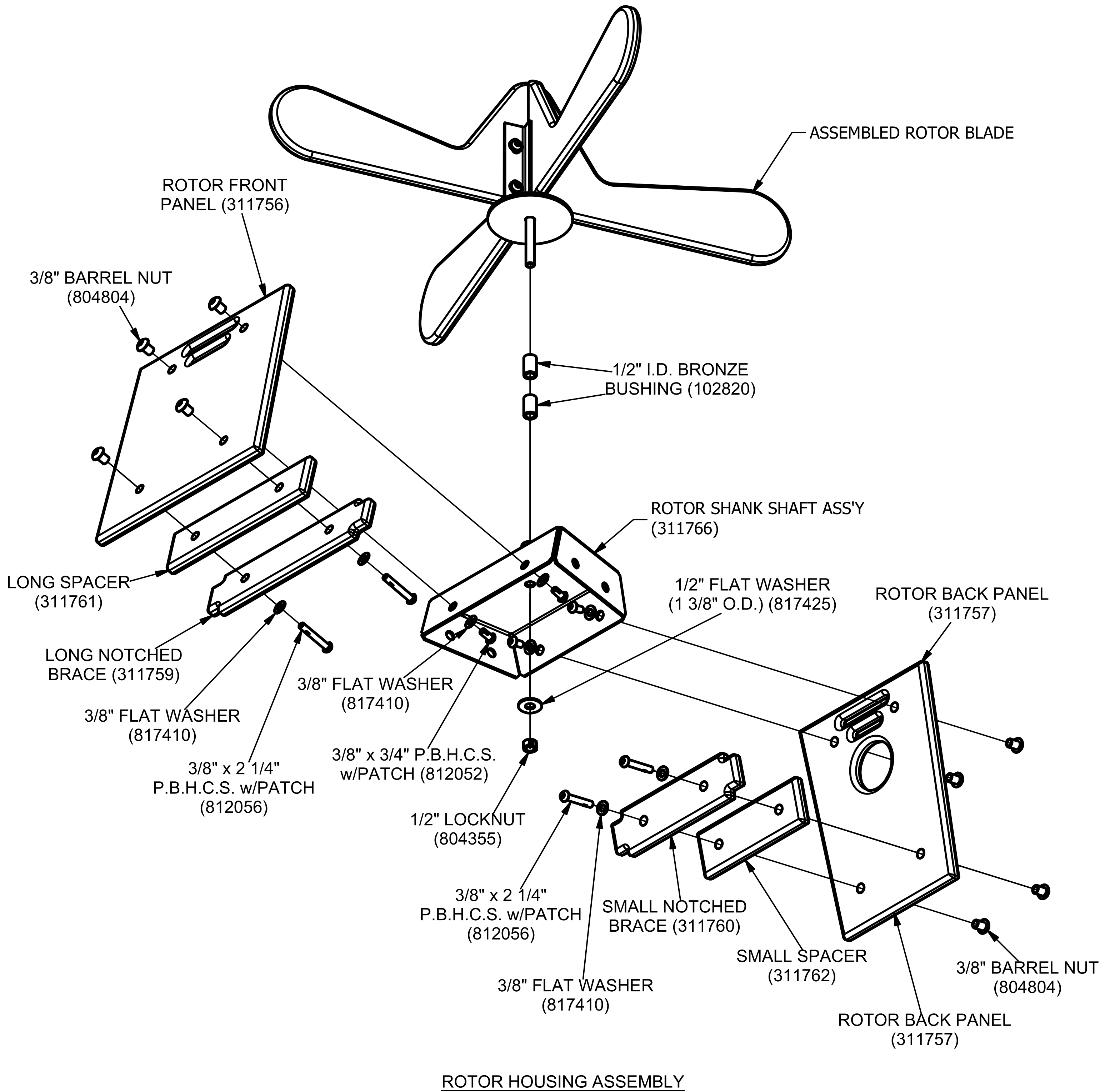

EC-126 Helicopter
EC-126S Helicopter - Surface Mount

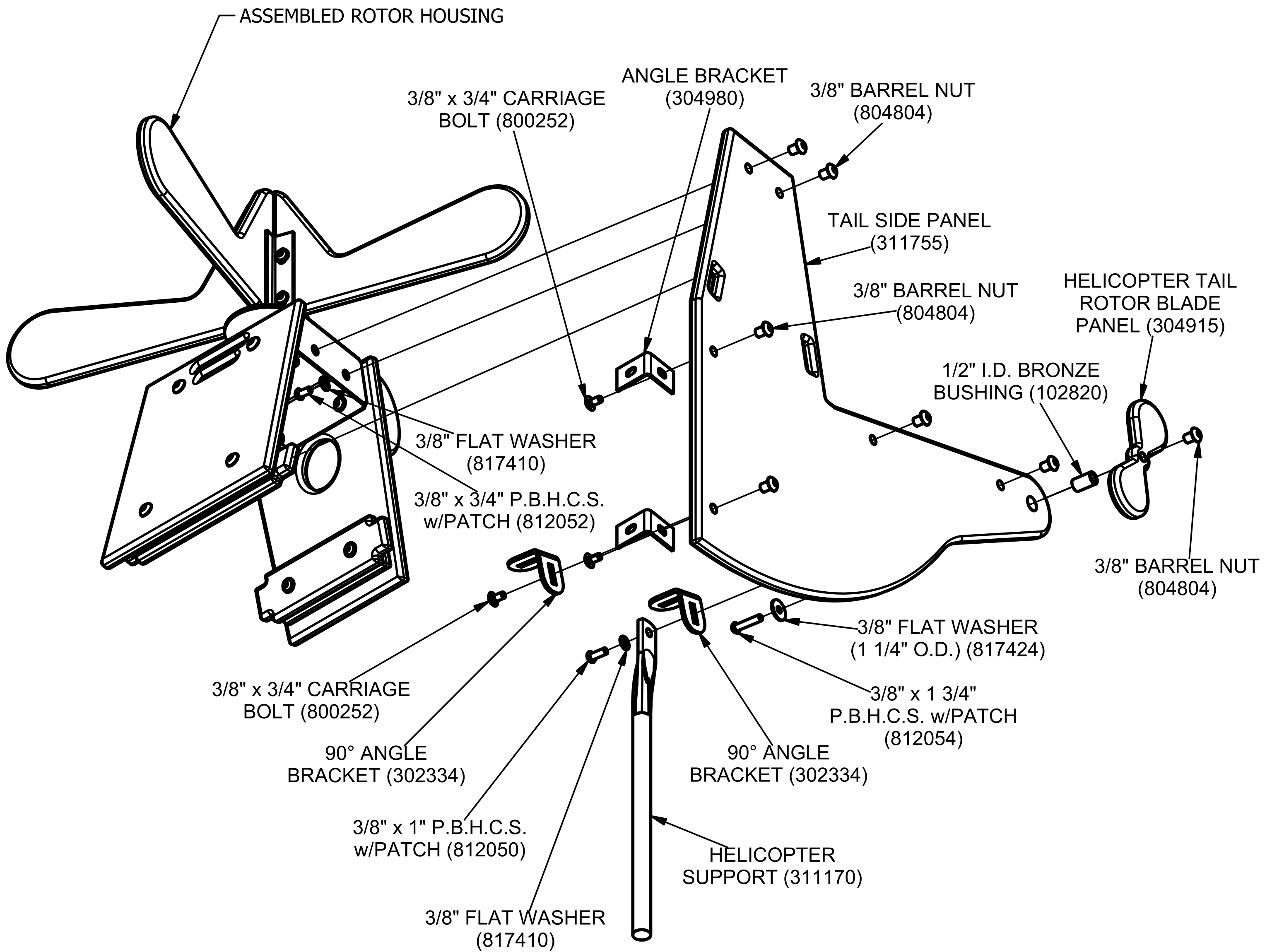

SIDE PANEL ASSEMBLY

EC-126 Helicopter
EC-126S Helicopter - Surface Mount

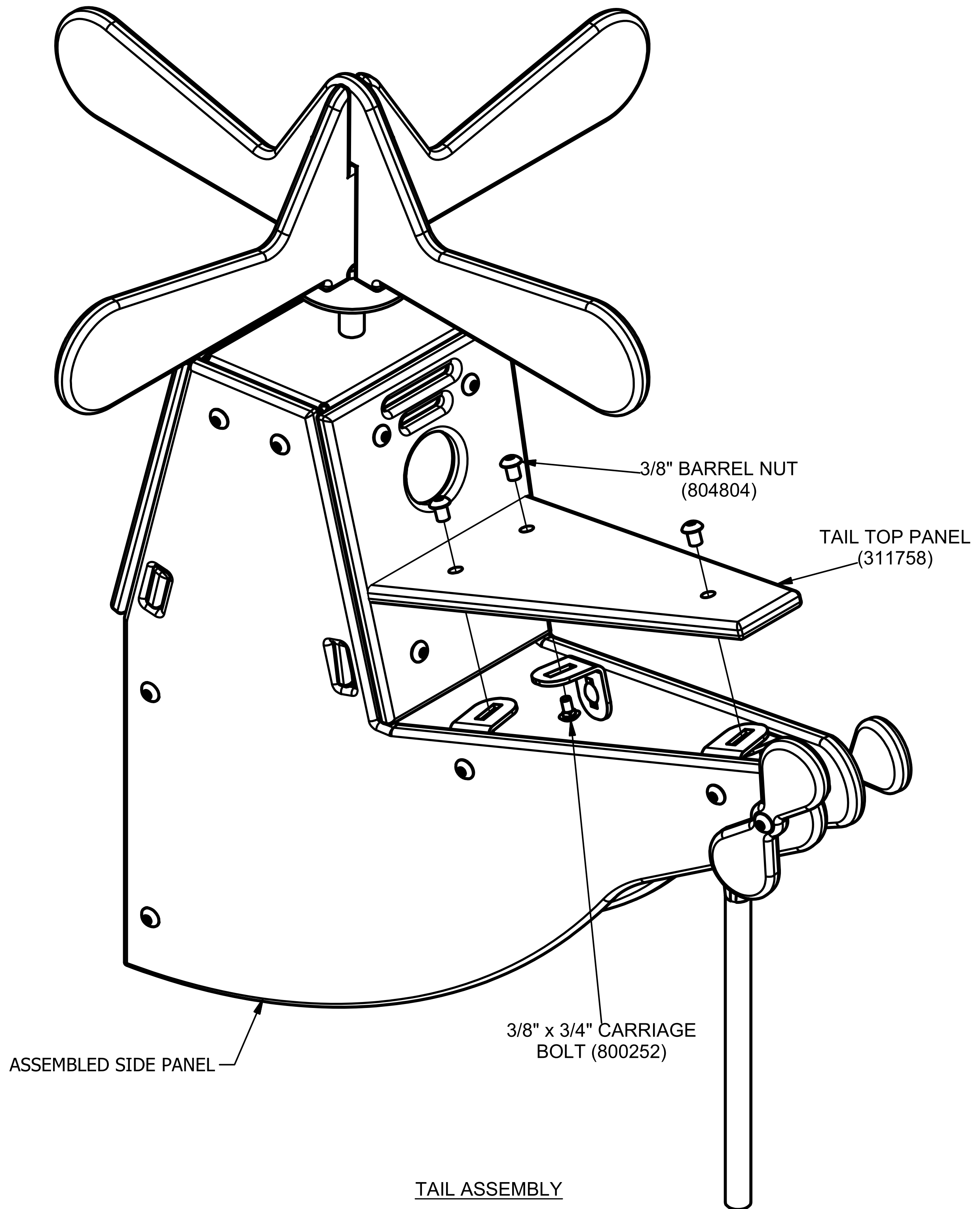

EC-126 Helicopter
EC-126S Helicopter - Surface Mount

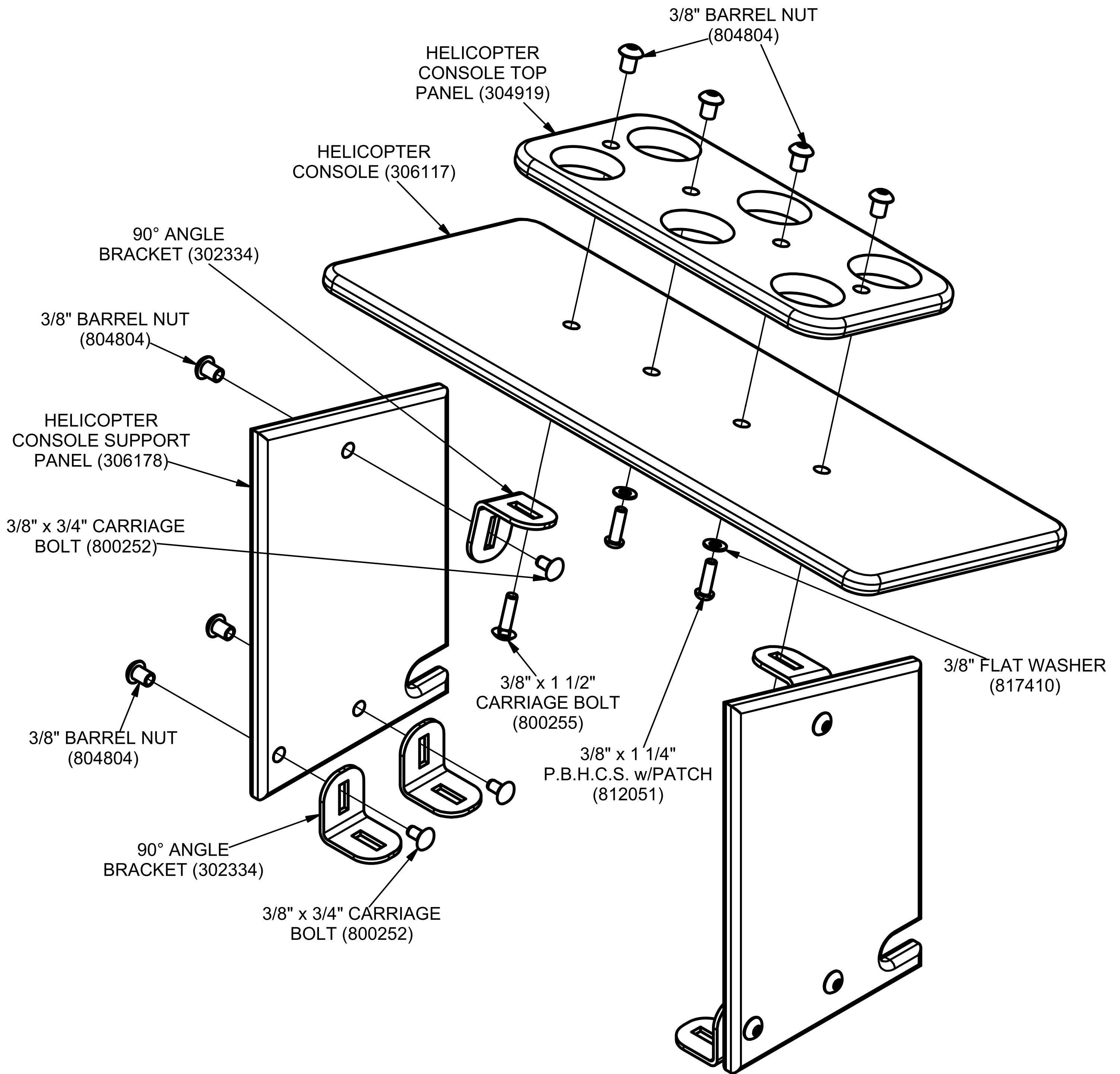

CONSOLE ASSEMBLY

EC-126 Helicopter
EC-126S Helicopter - Surface Mount

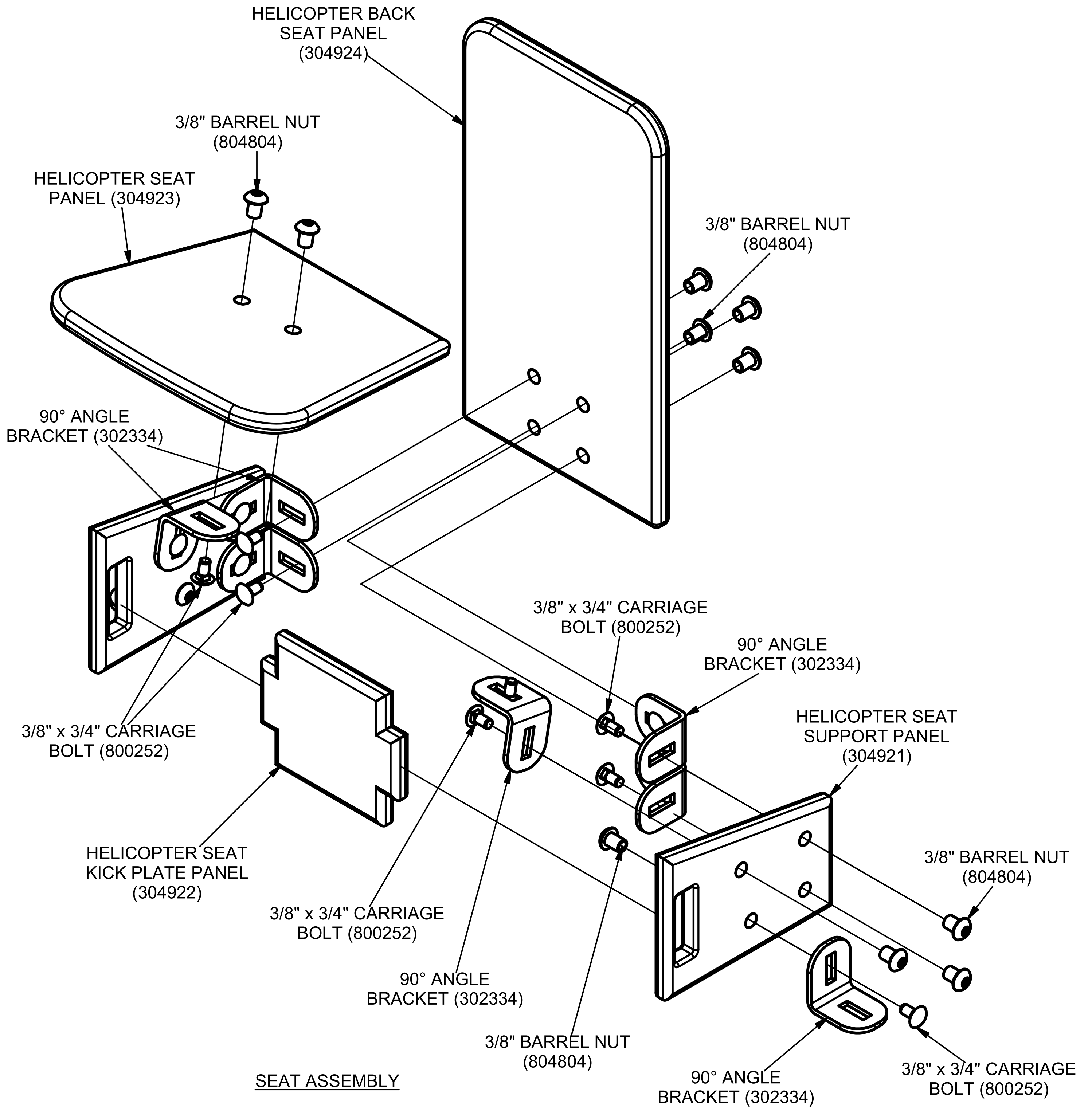

EC-126 Helicopter
EC-126S Helicopter - Surface Mount

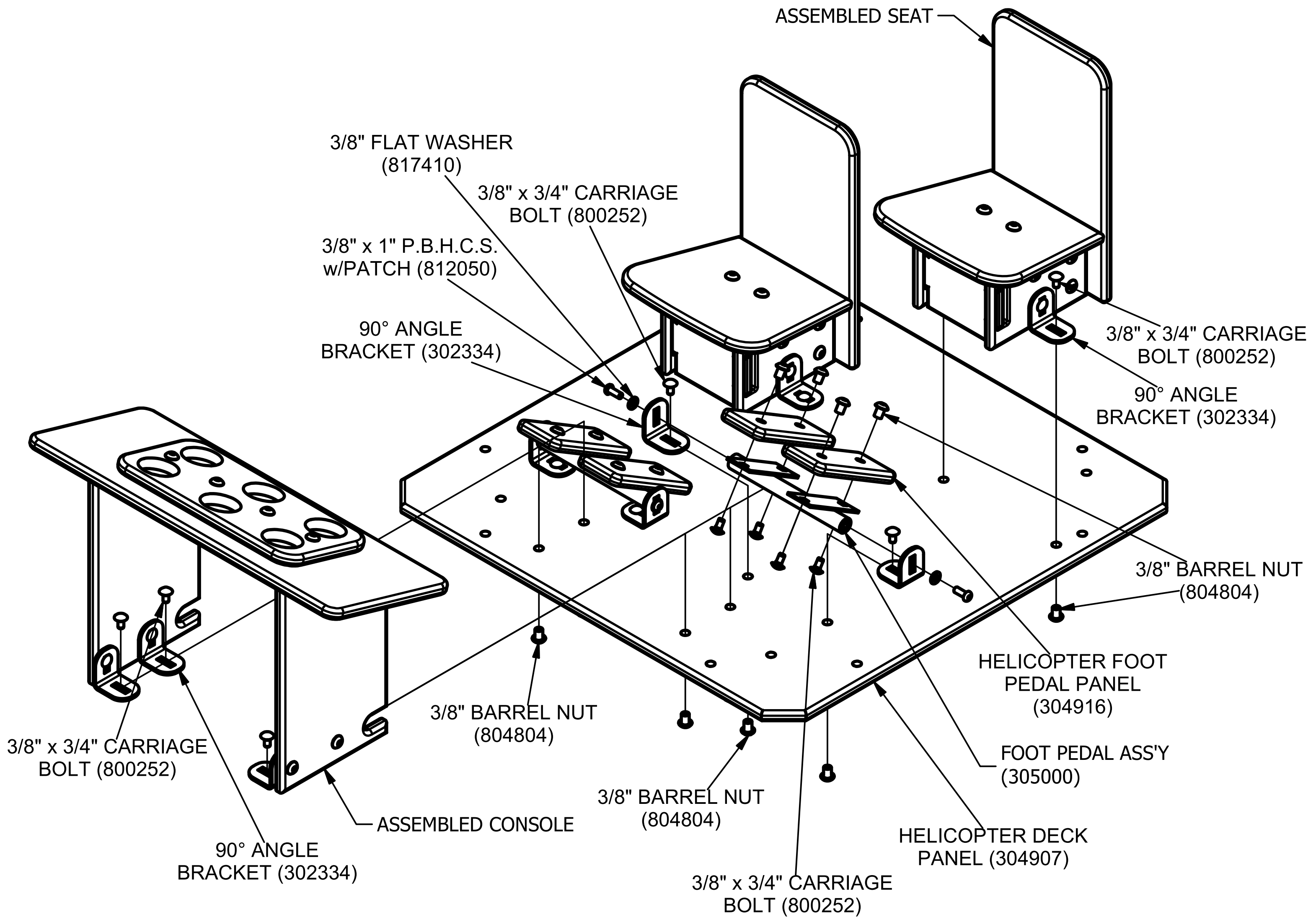

DECK ASSEMBLY

EC-126 Helicopter
EC-126S Helicopter - Surface Mount

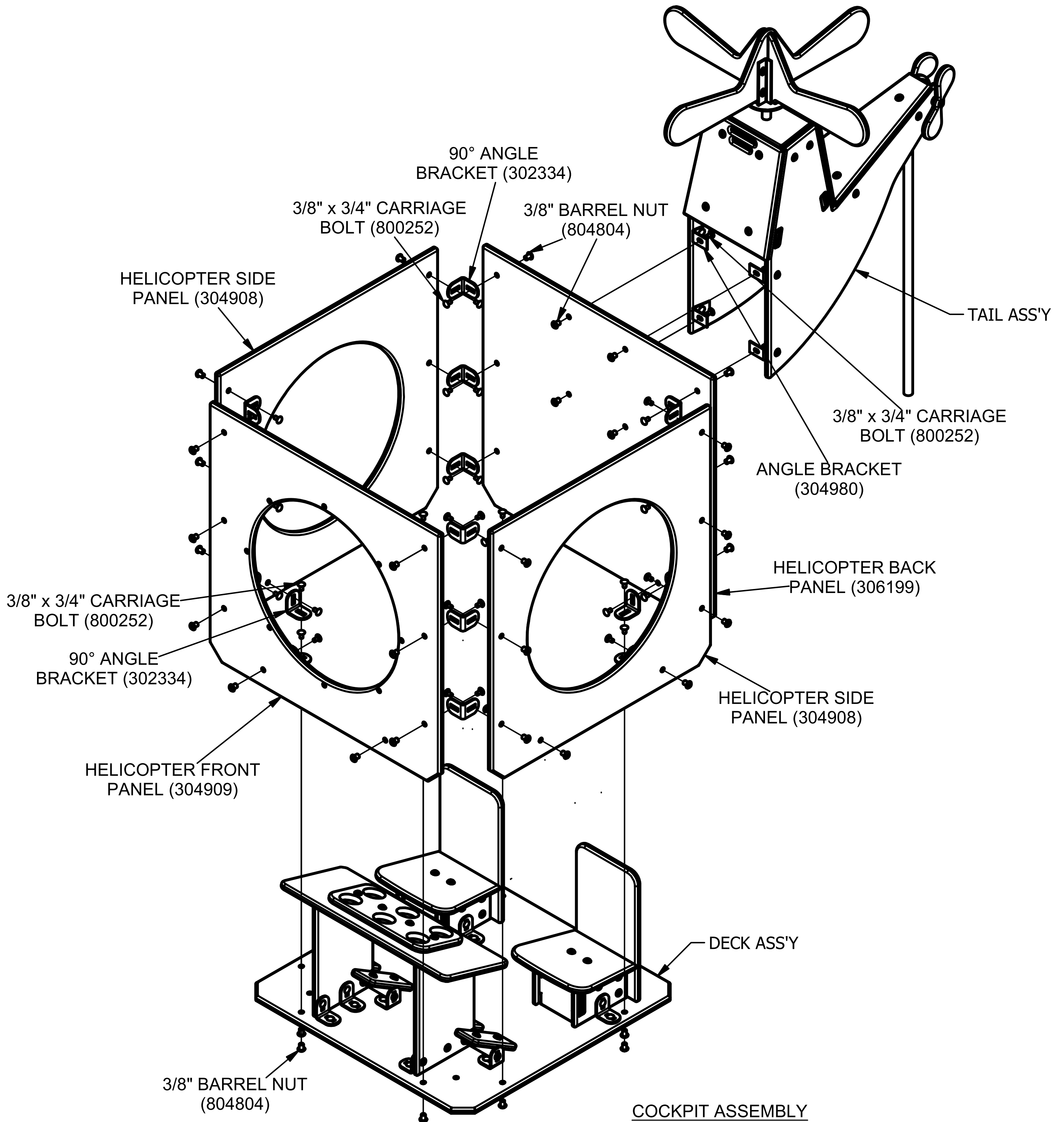

EC-126 Helicopter
EC-126S Helicopter - Surface Mount

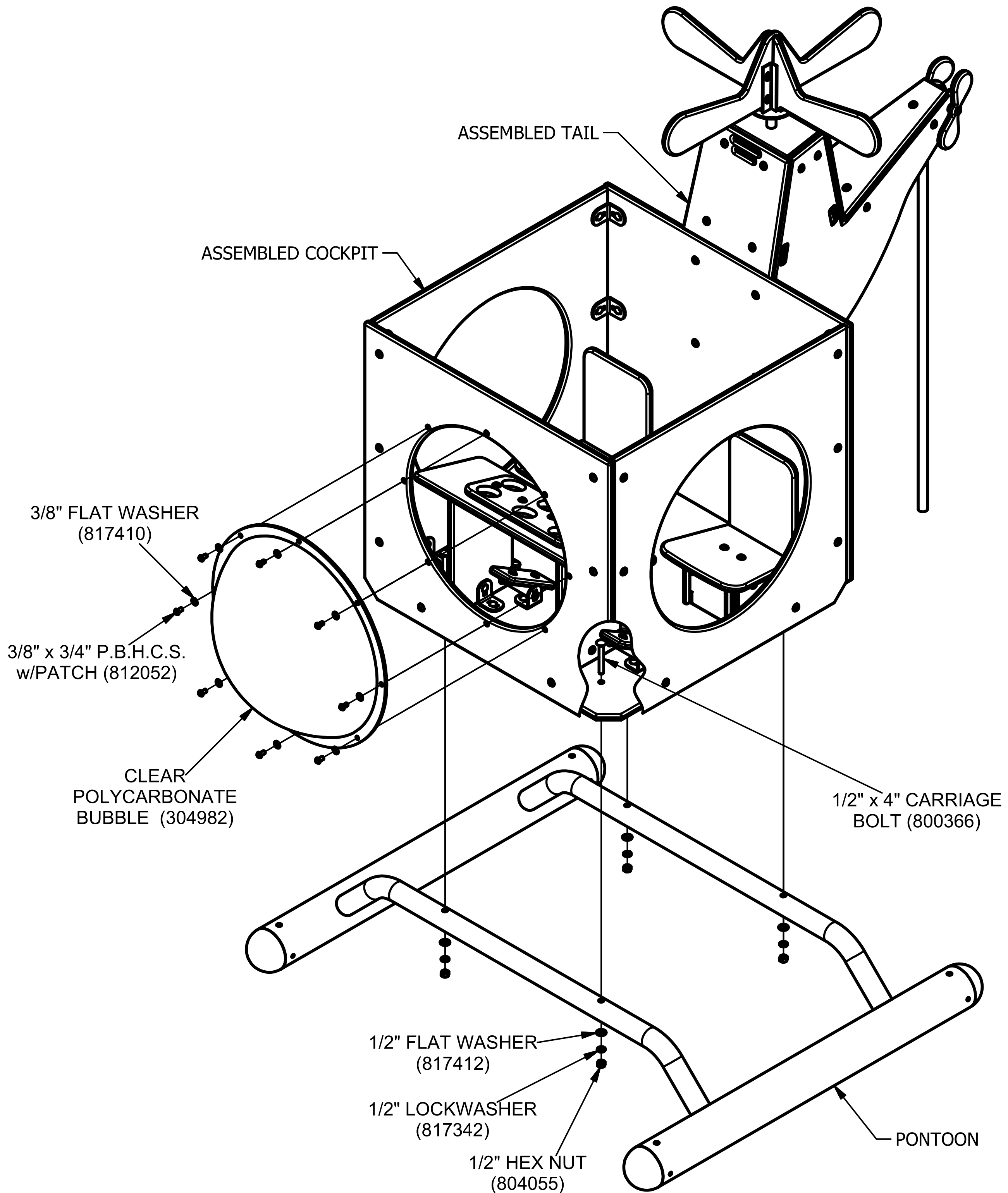

EC-126 Helicopter
EC-126S Helicopter - Surface Mount

